

LICENSING ACT 2003

Premises Licence

Schedule 12 Part A (Regulation 33,34) HARROW COUNCIL, P O BOX 18, STATION ROAD, HARROW

Premises Licence Number:	LN/000008921/2018/3
--------------------------	---------------------

Part 1 – Premises details

Postal address of premises, or if none, ordnance survey map reference or description: Bombay Central, 328 High Road, Harrow, Middlesex, HA3 6HS
Telephone Number: N/A

Where the licence is time limited, the dates: N/A
--

Licensable activities authorised by the licence: Hours open to public Sale of retail alcohol Late night refreshment Live music (e) Performance of dances (g) Performance similar to e f g Recorded music (f)
--

Signed by Richard LeBrun Environmental Services Manager (Public Protection)

Basement Floor**Hours open to public**

Sunday	00:00 - 02:00	08:00 - 00:00
Monday	00:00 - 02:00	08:00 - 00:00
Tuesday	00:00 - 02:00	08:00 - 00:00
Wednesday	00:00 - 02:00	08:00 - 00:00
Thursday	00:00 - 02:00	08:00 - 00:00
Friday	00:00 - 02:00	08:00 - 00:00
Saturday	00:00 - 02:00	08:00 - 00:00

Terminal hours to be extended to from 08:00 - 04:00 (the following morning) on New Years Eve

The times the licence authorises the carrying out of licensable activities**Location: Ground Floor****Hours open to public**

Sunday	00:00 - 01:00	08:00 - 00:00
Monday	00:00 - 01:00	08:00 - 00:00
Tuesday	00:00 - 01:00	08:00 - 00:00
Wednesday	00:00 - 01:00	08:00 - 00:00
Thursday	00:00 - 01:00	08:00 - 00:00
Friday	00:00 - 01:00	08:00 - 00:00
Saturday	00:00 - 01:00	08:00 - 00:00

Terminal hours to be extended to from 08:00 - 04:00 (the following morning) on New Years Eve

Location: Basement Floor**Sale of retail alcohol**

Sunday	00:00 - 01:00	10:00 - 00:00
Monday	00:00 - 01:00	10:00 - 00:00
Tuesday	00:00 - 01:00	10:00 - 00:00
Wednesday	00:00 - 01:00	10:00 - 00:00
Thursday	00:00 - 01:00	10:00 - 00:00
Friday	00:00 - 01:00	10:00 - 00:00
Saturday	00:00 - 01:00	10:00 - 00:00

Off sales are limited to take aways and partly consumed bottles of wine

Terminal hours to be extended to from 08:00 - 03:00 (the following morning) on New Years Eve

Location: Ground Floor**Sale of retail alcohol**

Sunday	10:00 - 00:00	-
Monday	10:00 - 00:00	-
Tuesday	10:00 - 00:00	-
Wednesday	10:00 - 00:00	-
Thursday	10:00 - 00:00	-
Friday	10:00 - 00:00	-
Saturday	10:00 - 00:00	-

Off sales are limited to take aways and partly consumed bottles of wine

Terminal hours to be extended to from 08:00 - 03:00 (the following morning) on New Years Eve

Location: Basement Floor**Late night refreshment**

Sunday	00:00 - 01:30	23:00 - 00:00
Monday	00:00 - 01:30	23:00 - 00:00
Tuesday	00:00 - 01:30	23:00 - 00:00
Wednesday	00:00 - 01:30	23:00 - 00:00
Thursday	00:00 - 01:30	23:00 - 00:00
Friday	00:00 - 01:30	23:00 - 00:00
Saturday	00:00 - 01:30	23:00 - 00:00

Terminal hours to be extended to from 08:00 - 03:00 (the following morning) on New Years Eve

Location: Ground Floor

Late night refreshment

Sunday	23:00 - 00:00	-
Monday	23:00 - 00:00	-
Tuesday	23:00 - 00:00	-
Wednesday	23:00 - 00:00	-
Thursday	23:00 - 00:00	-
Friday	23:00 - 00:00	-
Saturday	23:00 - 00:00	-

Terminal hours to be extended to from 08:00 - 03:00 (the following morning) on New Years Eve

Location: Basement Floor

Live music (e) Performance of dances (g) Performance similar to e f g

Sunday	00:00 - 01:00	10:00 - 00:00
Monday	00:00 - 01:00	10:00 - 00:00
Tuesday	00:00 - 01:00	10:00 - 00:00
Wednesday	00:00 - 01:00	10:00 - 00:00
Thursday	00:00 - 01:00	10:00 - 00:00
Friday	00:00 - 01:00	10:00 - 00:00
Saturday	00:00 - 01:00	10:00 - 00:00

The above timings are for Basement only. There is no live music in Ground Floor. The live music will be amplified.

Terminal hours to be extended to from 08:00 - 03:00 (the following morning) on New Years Eve

Location: Basement Floor

Recorded music (f)

Sunday	00:00 - 01:00	10:00 - 00:00
Monday	00:00 - 01:00	10:00 - 00:00
Tuesday	00:00 - 01:00	10:00 - 00:00
Wednesday	00:00 - 01:00	10:00 - 00:00
Thursday	00:00 - 01:00	10:00 - 00:00
Friday	00:00 - 01:00	10:00 - 00:00
Saturday	00:00 - 01:00	10:00 - 00:00

Terminal hours to be extended to from 08:00 - 03:00 (the following morning) on New Years Eve

Where the licence authorises supplies of alcohol – whether these are on and/or off supplies
Sale by retail on/off premises

Part 2

Name, (registered) address, telephone number and email (where relevant of holder of premises licence):

Dine India (London) Ltd

Registered number of holder, for example company number, charity number (where applicable):

08021399

Name, address and telephone number of designated premises supervisor where the premises licence

authorises for the supply of alcohol:

Personal licence number and issuing authority of personal licence held by designated premises supervisor – where the premises licence authorises for the supply of alcohol:

LANCASTER - LAPA1072

State whether access to the premises by children is restricted or prohibited: **N/A**

Annex 1 – Mandatory Conditions

Mandatory conditions where licence authorises supply of alcohol:

- 1 No supply of alcohol may be made under the premises licence -
 - a) at a time when there is no designated premises supervisor in respect of the premises licence, or
 - b) at a time when the designated premises supervisor does not hold a personal licence or his personal licence is suspended
2. Every supply or sale of alcohol made under the premises licence must be made or authorised by a person who holds a personal licence.

Mandatory condition where licence requires door supervision:

Where one or more individuals are required to be at the premises to carry out a security activity, such individual(s) must be licensed by the Security Industry Authority.

The Licensing Act 2003 (Mandatory Licensing Conditions) (Amendment) Order 2014

1. (1) The responsible person must ensure that staff on relevant premises do not carry out, arrange or participate in any irresponsible promotions in relation to the premises.
(2) In this paragraph, an irresponsible promotion means any one or more of the following activities, or substantially similar activities, carried on for the purpose of encouraging the sale or supply of alcohol for consumption on the premises—
 - (a) games or other activities which require or encourage, or are designed to require or encourage, individuals to—
 - (i) drink a quantity of alcohol within a time limit (other than to drink alcohol sold or supplied on the premises before the cessation of the period in which the responsible person is authorised to sell or supply alcohol), or
 - (ii) drink as much alcohol as possible (whether within a time limit or otherwise);
 - (b) provision of unlimited or unspecified quantities of alcohol free or for a fixed or discounted fee to the public or to a group defined by a particular characteristic in a manner which carries a significant risk of undermining a licensing objective;
 - (c) provision of free or discounted alcohol or any other thing as a prize to encourage or reward the purchase and consumption of alcohol over a period of 24 hours or less in a manner which carries a significant risk of undermining a licensing objective;
 - (d) selling or supplying alcohol in association with promotional posters or flyers on, or in the vicinity of, the premises which can reasonably be considered to condone, encourage or glamorise anti-social behaviour or to refer to the effects of drunkenness in any favourable manner;
 - (e) dispensing alcohol directly by one person into the mouth of another (other than where that other person is unable to drink without assistance by reason of disability).
2. The responsible person must ensure that free potable water is provided on request to customers where it is reasonably available.
3. (1) The premises licence holder or club premises certificate holder must ensure that an age verification policy is adopted in respect of the premises in relation to the sale or supply of alcohol.
(2) The designated premises supervisor in relation to the premises licence must ensure that the supply of alcohol at the premises is carried on in accordance with the age verification policy.

(3) The policy must require individuals who appear to the responsible person to be under 18 years of age (or such older age as may be specified in the policy) to produce on request, before being served alcohol, identification bearing their photograph, date of birth and either—

- (a) a holographic mark, or
- (b) an ultraviolet feature.

4. The responsible person must ensure that—

(a) where any of the following alcoholic drinks is sold or supplied for consumption on the premises (other than alcoholic drinks sold or supplied having been made up in advance ready for sale or supply in a securely closed container) it is available to customers in the following measures—

- (i) beer or cider: ½ pint;
- (ii) gin, rum, vodka or whisky: 25 ml or 35 ml; and
- (iii) still wine in a glass: 125 ml;

(b) these measures are displayed in a menu, price list or other printed material which is available to customers on the premises; and

(c) where a customer does not in relation to a sale of alcohol specify the quantity of alcohol to be sold, the customer is made aware that these measures are available.”

Mandatory Condition order 2014

1. A relevant person shall ensure that no alcohol is sold or supplied for consumption on or off the premises for a price which is less than the permitted price.

2. For the purposes of the condition set out in paragraph 1—

(a) “duty” is to be construed in accordance with the Alcoholic Liquor Duties Act 1979

(b) “permitted price” is the price found by applying the formula—

$$P = D + (D \times V)$$

where—

- (i) P is the permitted price,
- (ii) D is the rate of duty chargeable in relation to the alcohol as if the duty were charged on the date of the sale or supply of the alcohol, and
- (iii) V is the rate of value added tax chargeable in relation to the alcohol as if the value added tax were charged on the date of the sale or supply of the alcohol;

(c) “relevant person” means, in relation to premises in respect of which there is in force a premises licence—

- (i) the holder of the premises licence,
 - (ii) the designated premises supervisor (if any) in respect of such a licence, or
 - (iii) the personal licence holder who makes or authorises a supply of alcohol under such a licence;
- (d) “relevant person” means, in relation to premises in respect of which there is in force a club premises certificate, any member or officer of the club present on the premises in a capacity which enables the member or officer to prevent the supply in question; and
- (e) “valued added tax” means value added tax charged in accordance with the Value Added Tax Act 1994

3. Where the permitted price given by Paragraph (b) of paragraph 2 would (apart from this paragraph) not be a whole number of pennies, the price given by that sub-paragraph shall be taken to be the price actually given by that sub-paragraph rounded up to the nearest penny.

4. (1) Sub-paragraph (2) applies where the permitted price given by Paragraph (b) of paragraph 2 on a day (“the first day”) would be different from the permitted price on the next day (“the second day”) as a result of a change to the rate of duty or value added tax.

(2) The permitted price which would apply on the first day applies to sales or supplies of alcohol which take place before the expiry of the period of 14 days beginning on the second day.

Mandatory conditions where licence authorises exhibition of films:

(1) The admission of persons under the age of 18 years to exhibitions of films must be restricted in accordance with any recommendation made by the British Board of Film Classification, except where condition 2 applies.

(2) The admission of persons under the age of 18 years to exhibitions of films must be restricted in accordance with any recommendation made by the relevant licensing authority regarding the film in question

Annex 2 - Conditions consistent with the Operating Schedule

1. The CCTV system to be maintained and operated in good order and to the satisfaction of the Metropolitan Police's reasonable requests as documented in the Harrow Police Security Recommendations document. The medium upon which the images are recorded will be clearly identifiable, stored securely, retained for a period of not less than 31 days and it will be made available to Council Officers and Police immediately upon request.
2. As per Mandatory Conditions - The Licensing Act 2003 (Mandatory Licensing Conditions) (Amendment) Order 2014 the age verification policy shall apply to persons who appear to be under the age of 21 years old ("Challenge 21 policy"). All staff shall receive training with regard to the Challenge 21 Policy. The record will be made available to officers of the Metropolitan Police and the local authority immediately upon request.
3. A record of any incident that takes place at the premises which would undermine one or more of the four licensing objectives to be kept at the premises. The record will be made available to officers of the Metropolitan Police and the local authority immediately upon request.
4. All staff will be trained to a suitable level to identify public safety matters and any such concerns will be recorded in the incident book.
5. Prominent, clear and legible notices shall be displayed at the entrance/exit requesting patrons to respect the needs of local residents and to leave the premises and the area quietly.
6. When live or recorded music either amplified or unamplified is played the volume of the music will be kept to a level that ensures that no nuisance is caused to nearby residents.
7. All windows and doors will be kept closed (except for entry and exit) during the times regulated entertainment takes place.
8. Door supervisors will be employed at the premises from 23.00 until the terminal hour the following morning on Friday and Saturday nights at a ratio of 1 door supervisor to every 50 persons on the premises. The car park area will be monitored by the door supervisors to ensure persons who are exiting the venue disperse quickly and quietly so as not to cause a nuisance to nearby residents.
9. When the basement is booked for events beyond midnight (other than on a Friday or Saturday night) there will be at least two door supervisors employed at the premises from 23.00 until the terminal hour the following morning. The car park area will be monitored by the door supervisors to ensure persons who are exiting the venue disperse quickly and quietly so as not to cause a nuisance to nearby residents.

Annex 3 - Conditions attached after a hearing by the Licensing Authority

1. Off sales of alcohol are limited to alcohol purchased at the same time as takeaway meals only.

Annex 4 – Plan

<p>PROJECT: [illegible]</p> <p>DATE: [illegible]</p> <p>SCALE: [illegible]</p> <p>DESIGNER: [illegible]</p> <p>CLIENT: [illegible]</p> <p>LOCATION: [illegible]</p> <p>PROJECT NO: [illegible]</p> <p>DATE: [illegible]</p> <p>SCALE: [illegible]</p> <p>DESIGNER: [illegible]</p> <p>CLIENT: [illegible]</p> <p>LOCATION: [illegible]</p> <p>PROJECT NO: [illegible]</p>	<p>Dawvale</p> <p>100, [illegible] LONDON, E15 3JG</p> <p>020 300 0000</p> <p>www.dawvale.co.uk</p>
---	--

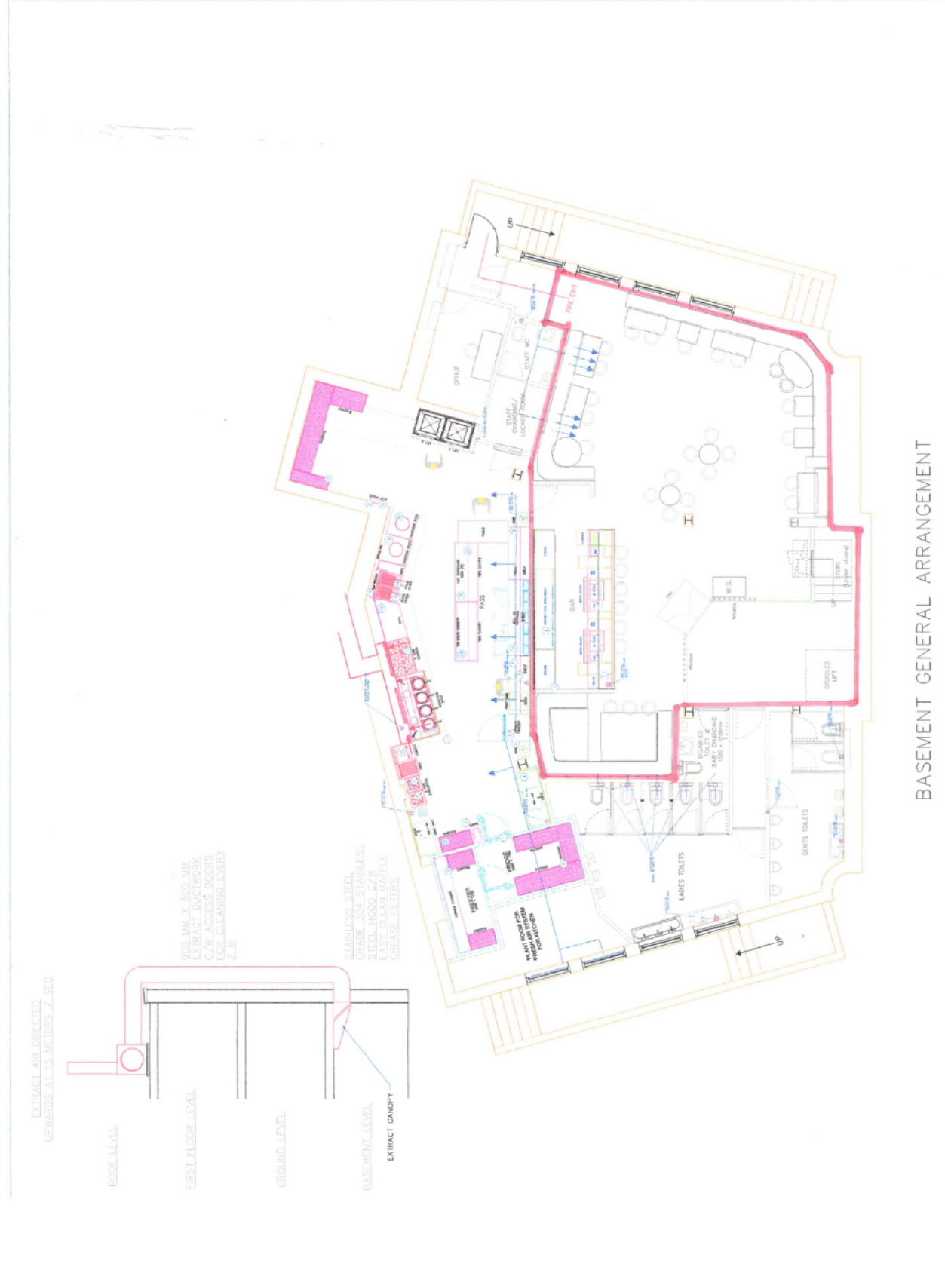

BASEMENT GENERAL ARRANGEMENT

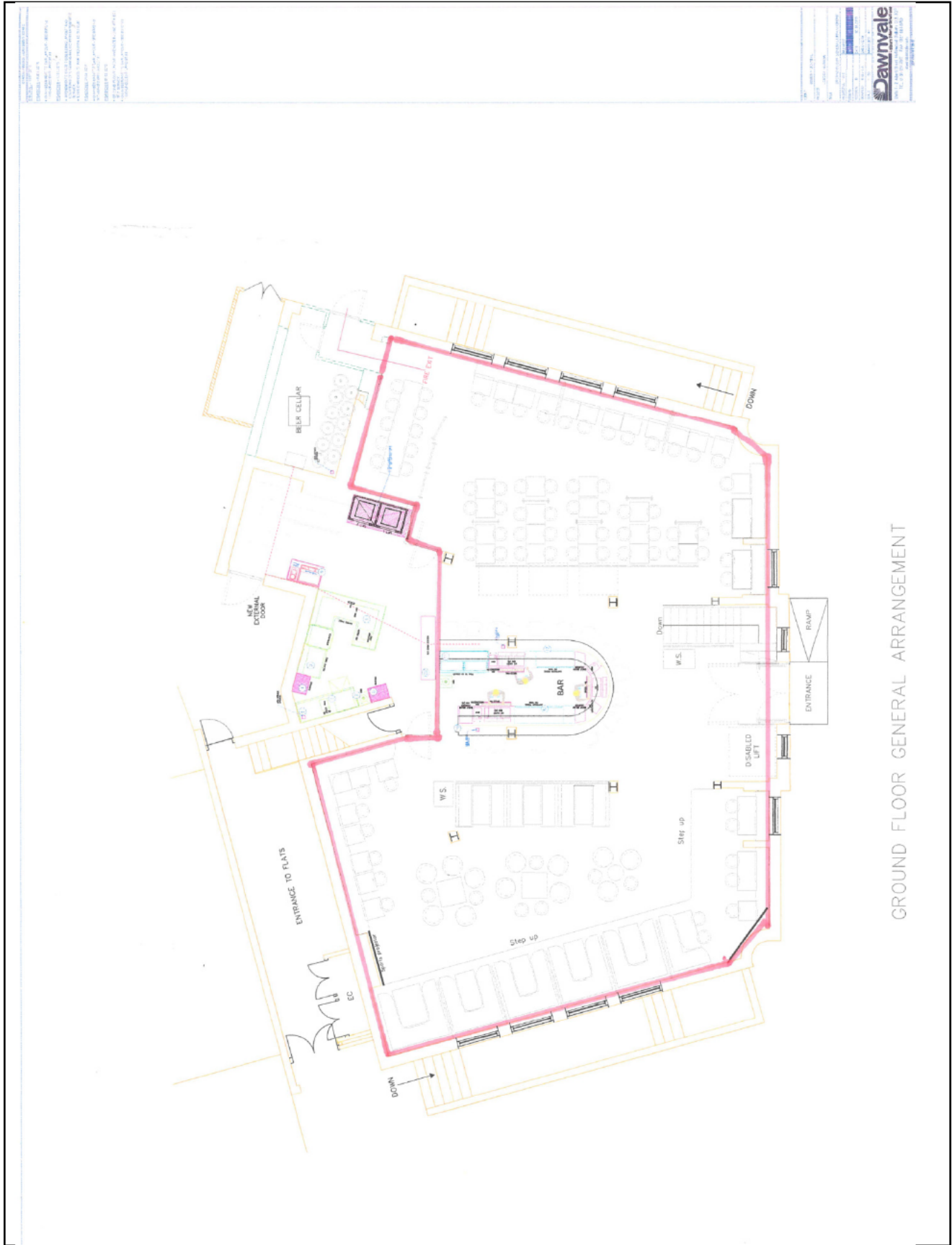

GROUND FLOOR GENERAL ARRANGEMENT

Date of original grant: 05/01/2016	Reason for issue: Variation Of DPS
Date of issue: 14th February 2018	Issue Number: 3